

**System dies size I (flat design)**

suitable for hand operated hydraulic compression tools Part-No. 12930/12933 acc. to catalogue page 169 as well as battery operated hydraulic compression tools Part-No. 14240/42 acc. to page 174, 12748 acc. to page 176 and Part-No. 12728 acc. to page 186.

**Indent-crimping 6-70 mm<sup>2</sup>**

for cable lugs acc. to DIN 46234 + 46230

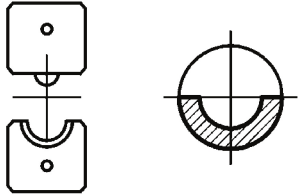

Part-No.	cross-section mm <sup>2</sup>	information
12680	10 + 16 + 25 + 35	When ordering the dies 12680-82 it is necessary to order the suitable indentor 12683 too. All crimping dies can be installed in our tools 12930/12933, 14240/42, 12748 and 12728.
12681	6 + 50	
12682	70	
12683	Indentor 6 - 70	

**Indent-crimping 1,5-35 mm<sup>2</sup>**

for druseidt stainless steel cable lugs

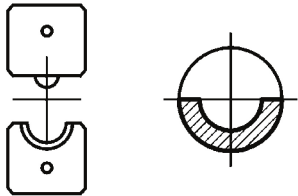

Part-No.	cross-section mm <sup>2</sup>	information
12503	1,5 - 2,5	All crimping dies can be installed in our tools 12930/12933, 14240/42, 12748 and 12728. Up to a cross-section range of 35 mm <sup>2</sup> it is necessary to work for copper and stainless steel cables with different crimping dies.
12504	4-6	
12505	10	
12506	16	
12507	25	
12508/VA	35	
12508/CU	35	

**WM-crimping 10-300 mm<sup>2</sup>**

for tubular cable lugs and connectors druseidt standard design, crimping width 5 mm

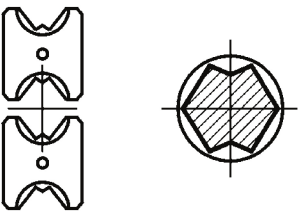

Part-No.	cross-section mm <sup>2</sup>	information
12923	10 + 120	Suitable tools for cross-section up to 240 mm <sup>2</sup> 12930/12933 and 12728 and for cross-section up to 300 mm <sup>2</sup> 14240/42 and 12748.
12924	16 + 70	
12925	25 + 95	
12926	35 + 50	
12927	150	
12928	185	
12929	240	
12929/300	300	

**WM-crimping 10-300 mm<sup>2</sup>**

for tubular cable lugs and connectors druseidt Euro-type design, crimping width 5 mm

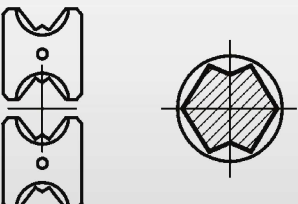

Part-No.	cross-section mm <sup>2</sup>	information
12400	10 + 120	Suitable tools for cross-section up to 240 mm <sup>2</sup> 12930/12933 and 12728 and for cross-section up to 300 mm <sup>2</sup> 14240/42 and 12748
12401	16 + 70	
12402	25 + 95	
12403	35 + 50	
12927	150	
12928	185	
12929	240	
12929/300	300	