

# Tower Sector: NANO TWS

## Tower Sector: NANO TWS

$V_{max} 24$	$^{\circ}C -30 +50$	autoestinguente self-extinguishing
--------------	---------------------	---------------------------------------

Adatto all'utilizzo interno - Indoor use

### Base di cablaggio + cappello Wiring base + cover



**NANO TWS B.C.**  
**NANOTWSBC**

⑪

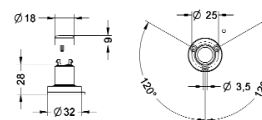

Kg. 0,014

NANOTWSBC	■	31587
NNANOTWSBC	■	31588

**Attenzione:** indispensabile nella composizione della colonna.  
**Attention:** to assemble the tower this item is essential.



$V 24 \sim (\pm 10\%)$	$\equiv$	$\sim$ 50/60 Hz	$\square$	$^{\circ}C -30 +50$
On $\infty$	$\leftarrow$	1 2 3 4 5 6	PC	autoestinguente self-extinguishing

Adatto all'utilizzo interno - Indoor use

### Modulo luminoso a led integrati luce fissa Led integrated continuous light module



**LD NANO TWS F**  
**LDNANOTWSF**

⑪

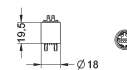

Kg. 0,004

$V \equiv$		24
$V \sim$		
●	mA	15
●	mA	15
●	mA	15
●	mA	15
●	mA	15
○	mA	15

LDNANOTWSF24DA1	●	31581
LDNANOTWSF24DA2	●	31582
LDNANOTWSF24DA3	●	31583
LDNANOTWSF24DA4	●	31584
LDNANOTWSF24DA5	●	31585
LDNANOTWSF24DA6	○	31586